



SEABOURN®

EXTRAORDINARY EXPEDITIONS

— 2021-2022 WINTER NORWAY INAUGURAL SEASON —



Our highest priorities are compliance, environmental protection, and protecting the health, safety and well-being of our guests, crew and the people in the destinations we visit. Visit Seabourn.com/TravelSafe to learn more.



EXPERIENCE THE AWE-INSPIRING BEAUTY

WINTER IN NORWAY IN AN UNPRECEDENTED ATMOSPHERE OF ELEGANCE AND EASE

Be among the first to savor a new era of ultra-luxury expedition travel combining authentic, exhilarating adventures in remote destinations with the uncompromising, sophisticated amenities of the world's finest resorts at sea.

1 DESIGNED FOR DISCOVERY – EQUIPPED FOR **EXPLORATION**

2 ALL-EXCLUSIVE, IMMERSIVE DESTINATION **EXPERIENCES**

3 AN UNCOMPROMISING **ULTRA-LUXURY** ONBOARD EXPERIENCE

4 THE **UNPARALLELED** SEABOURN EXPERIENCE YOU KNOW AND LOVE



We are staying atop COVID-19 health and safety protocols which may impact our voyages and offerings. Find out more at [Seabourn.com](https://www.seabourn.com)



1

DESIGNED FOR DISCOVERY - EQUIPPED FOR **EXPLORATION**

A WORLD-CLASS EXPEDITION TEAM

Your experienced Seabourn Expedition Team is a select group of academics, scientists and general naturalists who share your passion for exploring and learning about the world's remote regions. They bring all their masterful scholarly accomplishments and their logistic skills to facilitate unparalleled experiences. On board, they provide expert insights into the bio-diversity, ecosystems, physical science, history and culture of the places you visit, both in formal Seabourn Conversations presentations and casual discussions over meals or at leisure. They also guide your off-ship expedition to enhance and enrich your interaction and engagement with destinations.

ROBIN WEST



ROBIN WEST, VICE
PRESIDENT, EXPEDITION
OPERATIONS

VICE PRESIDENT, EXPEDITION OPERATIONS

Robin West is one of the most experienced and respected expedition leaders in the world. As Seabourn's Vice President of Expedition Operations, he hand-selects our Expedition Leaders and team members to ensure you will benefit from their expertise in a variety of disciplines, as well as their passion for adventure and discovery. Originally from South Africa, Robin began his adventure travel career as a scuba instructor and dive tour operator. His zeal for adventure led him to expedition cruising, and over the past 18 years, he has joined a small group of elite expedition travel specialists who guide voyages to the farthest reaches of the world.



SNOWMOBILE SAFARI, NORWAY



SKIING, NORWAY

ZODIACS® & KAYAKS

An impressive array of expedition equipment is available to all guests with our compliments: Superior quality gear from our prestigious partners enhances your adventure.

Zodiacs®: These sturdy watercrafts carry us ashore to remote locations where traditional landing facilities are absent.

Exciting options to enhance your expedition with exceptional adventures for an additional charge:

Kayaks: These lithe, beautiful boats let you approach things at water-level. Escorted by a member of our Expedition Team, our kayaks offer an appealing option available for an additional charge in many destinations.

KAYAKING, NORWAY



EQUIPPED FOR EXPLORATION: CUSTOM-BUILT SUBMARINES

Two six-person submarines offer unique and unforgettable undersea experiences to Seabourn Venture guests. Piloted by experienced Expedition Team submariners, these engineering marvels are capable of transporting guests beneath the surface, offering breathtaking views of plunging underwater cliffs and undersea life in fjords and the ocean. These exceptionally rare experiences are available for an additional charge in select destinations.

DESIGNED AND EQUIPPED FOR DISCOVERY

- Two technologically advanced submarines built by U-Boat Worx B.V. (The Netherlands)
- Interiors are luxuriously furnished with custom-embroidered upholstery, dual air conditioning systems, Bluetooth stereo sound and a Champagne cooler
- Two transparent spheres with seating for three guests each
- Seating platforms swivel 280 degrees for easy viewing on all sides
- Capable of multiple dives a day to depths up to 300 m/1,000 feet at 3 knots speed
- Powerful exterior lights reveal full color range, highlight a fascinating underwater world
- HD videocam systems record inside and outside action for later projection and souvenirs
- A six-function remote arm can be used to manipulate or retrieve objects outside the sub

SEABOURN VENTURE SUBMARINE



SEABOURN VENTURE SUBMARINE, INTERIOR



PARTNERSHIPS GEARED FOR EXPEDITION



HELLY HANSEN®

Seabourn is proud to partner with Helly Hansen to be our official outfitter, equipping our guests and crew with state-of-the-art outdoor expedition parkas or all-weather jackets, ensuring their complete comfort during their adventures on Arctic, Antarctic and Alaska voyages. The Norwegian company is the leader in developing technical sailing, skiing and exposure clothing enabling people to work and play in extreme outdoor environments since 1877. They introduced the first supple waterproof fabrics nearly 140 years ago, the first Lifa StaDry® technical base layers in the 1970s and have patented today's award-winning H²Flow™ temperature regulating system. In addition, Helly Hansen shares Seabourn's dedication to environmental sustainability and stewardship.



SWAROVSKI OPTIK

Seabourn continues its partnership making SWAROVSKI OPTIK the official precision optical equipment supplier for Seabourn. SWAROVSKI OPTIK outfits our Expedition Teams and bridge staff with their precision, long-range binoculars for navigation, spotting diverse wildlife and viewing the remarkable landscapes from on board the ship and during landings ashore. In addition, SWAROVSKI OPTIK spotting scopes are mounted on deck railings during scenic cruising, and their binoculars are supplied for use by guests occupying Premium Suites throughout the fleet, and all suites on board our expedition ships during their voyages. Wintergarden Suites on board expedition ships are further equipped with tripod-mounted SWAROVSKI OPTIK ATX spotting scopes with a 25-60x85 lens assembly for use during the voyage. SWAROVSKI OPTIK equipment can also be found in our onboard Shops on all Seabourn vessels.

2

ALL EXCLUSIVE, IMMERSIVE DESTINATION EXPERIENCES

2021-2022 WINTER NORWAY INAUGURAL SEASON

Winter in Norway's north is a magical season when long shadows tint the rugged alpine ranges, gilding granite peaks draped in shining mantles of snow. Fjord villages sparkle with twinkling lights, and the crisp, clear air is spiced with woodsmoke, it is a time Norwegians treasure. They venture outside to ski and snowshoe and ride their dogsleds. We'll join them, cruising towering fjords and kayaking among the snow-covered islands. Nights on deck are lit by luminescent clouds of stars and – often – majestic Northern Lights soar in silent grandeur over the peaks and glistening waters.



2021 / 2022 WINTER NORWAY EXPEDITION ITINERARIES

INAUGURAL

NORWAY, NORTHERN LIGHTS & NORTH CAPE
Greenwich (London) to Tromsø | 12 Days | DEC 11, 2021

- 1 Greenwich (London), England, UK^c
- 2 Greenwich (London), England, UK
- 3 Cruising the Thames River
- 4 Cruising the North Sea
- 5 Cruising the Norwegian Fjords
- 6 Bergen, Norway
- 7 Ålesund, Norway
- 8 Trondheim, Norway
- 9 Bodø, Norway
- 10 Svolveær (Lofoten), Norway
- 11 Andenes, Norway
- 12 Alta, Norway^c
- 13 Alta, Norway
- 14 Honningsvåg (Nordkapp), Norway
- 15 Passing the North Cape
- 16 Tromsø, Norway

^cOvernight on board.

NORWAY & NORTH CAPE - IN SEARCH OF NORTHERN LIGHTS
Copenhagen to Tromsø | 12 Days | JAN 6+, 18*, 30, FEB 23, MAR 7*, 19, 2022

- 1 Copenhagen, Denmark
- 2 Cruising the North Sea
- 3 Bergen, Norway
- 4 Ålesund, Norway
- 5 Trondheim, Norway
- 6 Bodø, Norway
- 7 Svolveær (Lofoten), Norway
- 8 Narvik, Norway
- 9 Harstad, Norway
- 10 Alta, Norway^c
- 11 Alta, Norway
- 12 Honningsvåg (Nordkapp), Norway
- 13 Passing the North Cape
- 14 Tromsø, Norway

* Sailings operate in reverse order.

* Ports and port orders may vary.

^cOvernight on board.

NORWEGIAN SPRING

Round-trip Tromsø | 10 Days | APR 24, 2022

- 1 Tromsø, Norway
- 2 Hammerfest, Norway
- 3 Passing the North Cape
- 4 Murmansk, Russia
- 5 Vardø, Norway
- 6 Honningsvåg (Nordkapp), Norway
- 7 Alta, Norway
- 8 Harstad, Norway
- 9 Bodø, Norway
- 10 Svolveær (Lofoten), Norway
- 11 Tromsø, Norway

Final details of our shore excursions programs will be available closer to departure.

HOLIDAY NORTHERN LIGHTS, NORTH CAPE & NORWAY
Tromsø to Copenhagen | 14 Days | DEC 23, 2021

- 1 Tromsø, Norway^c
- 2 Tromsø, Norway
- 3 Passing the North Cape
- 4 Honningsvåg (Nordkapp), Norway
- 5 Alta, Norway^c
- 6 Alta, Norway
- 7 Andenes, Norway
- 8 Narvik, Norway
- 9 Svolveær (Lofoten), Norway
- 10 Brønnøysund, Norway
- 11 Trondheim, Norway
- 12 Ålesund, Norway
- 13 Bergen, Norway
- 14 Cruising the Norwegian Sea
- 15 Copenhagen, Denmark

^cOvernight on board.

NORWAY & NORTH CAPE
Tromsø to Copenhagen | 12 Days | MAR 31, APR 12*, 2022

- 1 Tromsø, Norway
- 2 Passing the North Cape
- 3 Honningsvåg (Nordkapp), Norway
- 4 Alta, Norway^c
- 5 Alta, Norway
- 6 Harstad, Norway
- 7 Narvik, Norway
- 8 Svolveær (Lofoten), Norway
- 9 Bodø, Norway
- 10 Trondheim, Norway
- 11 Ålesund, Norway
- 12 Bergen, Norway
- 13 Cruising the Norwegian Sea
- 14 Copenhagen, Denmark

* Sailings operate in reverse order. Ports and port orders may vary.

^cOvernight on board.



CATHEDRAL, TROMSØ



SVOLVEÆR
The 'Lofoten Wall' rises from the sea like a towering granite symphony.

HARSTAD
From the large Hinnøya, explore a scattering of picturesque smaller isles nearby.

HAMMERFEST
A UNESCO World Heritage Site marks the start of the first meridian measurement.

BODØ
Experience the Saltstraumen, the world's most powerful tidal maelstrom

TRONDHEIM
Norway's ancient Viking capital with a gothic 12th-century cathedral.

ÅLESUND
Graceful Art Nouveau architecture surrounded by snow-draped Alpine ranges.

BERGEN
A 'City of Seven Mountains' is a well-preserved UNESCO World Heritage Site.

BRONNØYSUND
UNESCO inscribed the eiderdown culture of Vega Archipelago as World Heritage.

ALTA
Stay overnight for winter sports, Sami culture and a Seabourn Signature Event.

NARVIK
The Ofoten Railway runs through breathtaking scenery to the Swedish border.

VARDØ
The easternmost city in Norway lies east of St. Petersburg – and even Istanbul!

MURMANSK
This important ice-free Russian port is the largest city north of the Arctic Circle.



ABOVE: DOG SLEDDING, NORWAY



NORTHERN LIGHTS, NORWAY



BELOW: CAVE, NORWAY

COMPLIMENTARY POLARSHIELD PARKA

On our Winter Norway and Polar Expeditions, Seabourn will provide complimentary Helly Hansen jackets and backpacks to our guests. The PolarShield parkas have been custom-designed by Seabourn and Helly Hansen, featuring a Helly Tech® outer shell coupled with a removable insulator puff jacket inside.





GLACIER SIGHTSEEING, BERGEN

BERGEN

Unlike most medieval towns, **Bergen** has wide streets downtown, the result of long-ago fires. **Bryggen**, its Hanseatic wharf, is a UNESCO World Heritage Site. See the restored homes and cobbled streets of **Gamle Bergen**, ride a funicular up to the Floeien lookout, visit Bergenhus Fortress, and perhaps go out to **Troldhaugen**, the charming home of Edvard Grieg, with memorabilia of the composer's life and times.

INCLUSIVE EXPEDITION EXPERIENCES
Hanseatic Bryggen & Mt. Fløyen Walking Tour

OPTIONAL WINTER ACTIVITIES
Mountain Trek to Ovre Eide Farm ▪ Mountains & Fjords by Helicopter
▪ Helicopter Fjord & Glacier Sightseeing

Final Shore Excursions, both "Inclusive Expedition Experiences" and "Optional Winter Activities" are subject to change.

ÅLESUND

Following a fire in 1904, **Ålesund** was rebuilt in the Art Nouveau style. Its towers and turrets, backed by the Sunnmøre Alps, make it one of the loveliest towns in Norway. See it all from the top of **Mt. Aksla**, or close-up on a walking tour. The new Atlantic Sea Park is an aquarium and marine science center, and the city's snowy surroundings invite skiing in the Alps or snowshoeing in the breathtaking **Valdal valley**.

INCLUSIVE EXPEDITION EXPERIENCES

Art Nouveau walking tour of Ålesund's Charming Islands - **Giske & Godøy**

OPTIONAL WINTER ACTIVITIES

Sunnmøre Alps Helicopter Flight

Final Shore Excursions, both "Inclusive Expedition Experiences" and "Optional Winter Activities" are subject to change.

ÅLESUND, SKIING IN THE ALPS





TRONDHEIM, NORWAY

TRONDHEIM

See the 11th-century Gothic Nidaros cathedral and the Ringve Museum’s myriad musical instruments (all kept in tune!). Nearby **Røros** is a UNESCO World Heritage Site preserving an important 18th-Century mining town. **Sverresborg** open-air museum shows old wooden buildings and Thampsaviljongen is an ornate stave church built for the Chicago World’s Fair in 1893. Ski sports are the attraction in nearby **Bymarka** and **Vasfjellet**.

INCLUSIVE EXPEDITION EXPERIENCES

Trondheim Highlights

OPTIONAL WINTER ACTIVITY

An Entertaining & Culinary Visit at Bjørn’s Home

Final Shore Excursions, both “Inclusive Expedition Experiences” and “Optional Winter Activities” are subject to change.

BODØ

Bodø boasts the Nordic nations’ largest aeronautical museum and another with exhibits of Viking treasure, Sami life, the **Lofoten** fishery. See the city by kayak or take a thrilling RIB ride on the world’s strongest tidal maelstrom, Saltstraumen. Visit the copper-domed medieval Bodin Church. Dive, snorkel or take a heli-tour to the spectacular mountain ski resort of Jakobsbakken for snowshoeing, dogsledding and more.

INCLUSIVE EXPEDITION EXPERIENCES

National Norwegian Aviation Museum or Saltstraumen -
The World’s Strongest Tidal Current

OPTIONAL WINTER ACTIVITIES

Journey to the Arctic Circle ▪ Sami Experience ▪ Snowshoeing in the Arctic

Final Shore Excursions, both “Inclusive Expedition Experiences” and “Optional Winter Activities” are subject to change.

TENT AT SAMI CAMP





SNOWSHOEING, EGGUM

SVOLVÆR (LOFOTEN)

Fishermen flock to the towering **Lofoten islands** when the herring gather in winter. Artists adore their picturesque, rugged peaks, shining seas and extraordinary light conditions. When the tides are right, the currents between them create large maelstroms. Visit a traditional fishing camp, take a RIB between the islands, or a ride on small but mighty Icelandic horses. Kayaking and snorkeling are also on the agenda.

INCLUSIVE EXPEDITION EXPERIENCES

Lofoten Impressions - The Viking Museum

OPTIONAL WINTER ACTIVITIES

Snowshoeing Adventure to **Eggum - Lofoten Islands** by Helicopter

Final Shore Excursions, both “Inclusive Expedition Experiences” and “Optional Winter Activities” are subject to change.

NARVIK

This fjord town north of the Arctic Circle has a modern War Museum recounting its place in World War II, and another with displays about the culture of the nomadic Sami reindeer herders. Nearby is a Polar Park offering close-up looks at Arctic wildlife, and a cable car to the top of Fagernesfjellet peak, as well as the scenic Ofoten Railway that runs from **Narvik** through breathtaking fjords and mountains to **Sweden**.

INCLUSIVE EXPEDITION EXPERIENCES

Scenic Train Coach Ride over Swedish Border

OPTIONAL WINTER ACTIVITIES

Arctic Wildlife Center & Close-Up Wolf Encounter at Arctic Wildlife Center ▪
Fjord & Glacier by Helicopter

Final Shore Excursions, both “Inclusive Expedition Experiences” and “Optional Winter Activities” are subject to change.

SKYLIFT, CABLE CAR, NARVIK

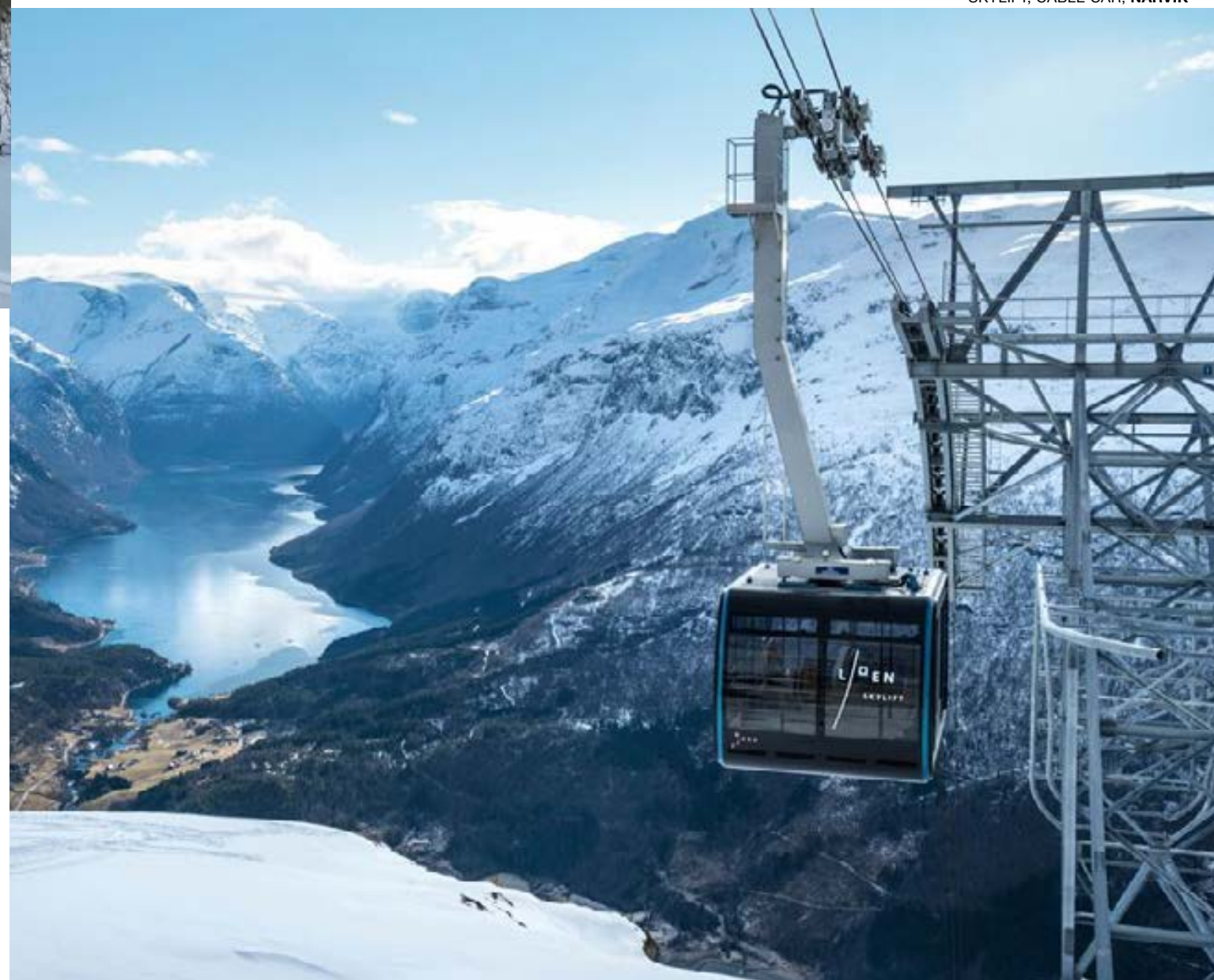



WHALE WATCHING

ANDENES

Andenes clings to the end of **Andøya island** in the **Vesterålen Archipelago**. It is an old fishing port with a tall, red 19th Century lighthouse. The Atlantic Continental Shelf is close offshore, and in winter herring attract humpback whales and orcas. The Aurora Space Center conducts Northern Lights research. Rugged **Bukkekerka** holds remnants of a village destroyed by a storm in 1879, Iron Age ruins and burial mounds.

INCLUSIVE EXPEDITION EXPERIENCES

Whale Watching with Onboard Presentation

OPTIONAL WINTER ACTIVITIES

Snorkeling with the Whales

Final Shore Excursions, both “Inclusive Expedition Experiences” and “Optional Winter Activities” are subject to change.

ALTA

Alta sits at the head of its namesake fjord on the coast of Norway’s northern Finnmark province. It is a popular place for visitors to view the Northern Lights in season, inspiring its soaring modern Northern Lights Cathedral. Walk the paths beside nearby **Hjemmeluft Bay**, viewing the thousands of petroglyphs and visiting the UNESCO World Heritage Rock Art Centre, or see the steep canyon of the Alta River south of town.

OPTIONAL WINTER ACTIVITIES

Visit the Magical Sorrisniva Igloo Hotel & Meet the Huskies & A Taste of Dog Sledding & Snowshoeing & Ice Fishing & Reindeer Sledding & Sami Traditions ▪ Overnight at Northern Lights Lodge & Overnight with the Huskies & Dog Sledding & Overnight at Sorrisniva Igloo Hotel

Final Shore Excursions, both “Inclusive Expedition Experiences” and “Optional Winter Activities” are subject to change.

SORRISNIVA, IGLOO HOTEL



NORTHERN LIGHTS CATHEDRAL

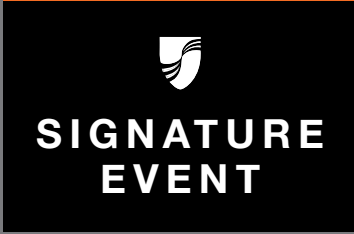

Signature Event

Concert in the Northern Lights Cathedral & Seabourn Signature Evening Event (Northern Lights Camp Pæskatun)

*Based on guests participating on both options over the 2-day call





KING CRAB PRESENTATION, HONNINGSVÅG FISHING PORT

HONNINGSVÅG

This working fishing port doubles as the access port for the North Cape cliffs on the windswept island of **Magerøy** nearby, marking the very top of the European continent. Its looming cliffs rise directly from the sea to a plateau as flat as a table. At 71° 10' 20" N latitude, it is just 1,306 mi/2012 km from the North Pole. Here the Norwegian Sea, part of the Atlantic Ocean, meets the Barents Sea in the Arctic Ocean.

INCLUSIVE EXPEDITION EXPERIENCES

Journey to North Cape & Onboard King Crab Presentation

OPTIONAL WINTER ACTIVITIES

North Cape Snowmobile Safari ▪ North Cape Flightseeing by Helicopter & VIP Helicopter and Visit to the North Cape

Final Shore Excursions, both "Inclusive Expedition Experiences" and "Optional Winter Activities" are subject to change.

TROMSØ, NORWAY (EMBARK/DISEMBARK)

Due to the warm Gulf Stream, **Tromsø's** harbor remains ice-free in winter and its climate is milder than other towns at the same latitudes. Numerous polar expeditions have set off from here and both Roald Amundsen and Fridtjof Nansen frequently recruited Tromsø men for expeditions to both polar regions. Landmarks include the distinctive Arctic Cathedral, the Tromsø University Museum and the unique Polar Museum.

INCLUSIVE EXPEDITION EXPERIENCES

Tromsø Sights & Explorations

Final Shore Excursions, both "Inclusive Expedition Experiences" and "Optional Winter Activities" are subject to change.

ARCTIC CATHEDRAL, TROMSØ





SCENIC FJORDS



ABOVE: QUIANT VILLAGE ON THE BANK OF A NORWEGIAN FJORD

BELOW: SEABOURN CONVERSATIONS LECTURE

CRUISING THE NORWEGIAN FJORDS

A unique feature of fjords cruising is the hours-long panorama of scenic beauty and points of interest that unfurls on either side of your ship. Quaint villages nestle on shore and tiny farms cling impossibly to mountainsides. Waterfalls tinsel the slopes, frequently frozen into bizarre sculptural artforms. Your Expedition Team photography and video expert will be on deck offering tips to help you capture the stunning scenes. Other Expedition Team members will be around on deck or in lounges to interpret the scenes, talk about the geology and natural history, answer questions or just to chat.



3

AN UNCOMPROMISING **ULTRA-LUXURY** ONBOARD EXPERIENCE

The shared guest areas on board Seabourn Venture are masterfully designed by luxury hospitality icon Adam. D. Tihany to facilitate the ship's prime objectives:

A casually elegant, luxury-rich environment encourages an engaging onboard social life, supporting the unique camaraderie born of sharing stimulating adventures.

RENDERING OF BOW LOUNGE



RENDERING OF EXPEDITON LOUNGE



RENDERING OF DISCOVERY CENTER



RENDERING OF THE LANDING ZONE

EXPEDITION LOUNGE

The social heart of Seabourn Venture is a comfortable, welcoming place where guests gather before and after their off-ship adventures.

LANDING ZONE

Where guests prepare for and return from off-ship expedition activities. Guests in each group can be deployed in Zodiacs® and off to their adventures within minutes.

THE CLUB

A casually elegant lounge with drinks, music and a dance floor, where light sushi bites are freshly made to order in the evening.

BOW LOUNGE

An inviting observation lounge offering panoramic views, a virtual bridge and easy access to the bow for unique wildlife encounters.

DISCOVERY CENTER

A superbly equipped learning center with a 30-foot video screen for enrichment and entertainment — and room for everyone.

CONSTELLATION LOUNGE

An oasis with a panoramic view, all the way forward and up top, inviting you to enjoy drinks, piano music and conversation anytime.



RENDERING OF PANORAMA VERANDA SUITE



RENDERING OF VERANDA SUITE



SEABOURN VENTURE SUITES

Your spacious suite welcomes you with complimentary Champagne and a fully stocked bar with your preferences. Thoughtfully designed for adventurers with features such as a personal heated wardrobe for expedition gear, they are also tastefully curated with fine furnishings. Our ocean-front suites all feature expansive views, opening onto private verandas for relaxing, wildlife or landscape viewing, or entertaining.

For full descriptions and amenities by suite category, visit Seabourn.com

RENDERING OF VERANDA SUITE BATHROOM



LEFT PAGE: RENDERING OF PENTHOUSE SUITE



RENDERING OF OWNER'S SUITE



RENDERING OF WINTERGARDEN SUITE, UPPER FLOOR

PENTHOUSE & PREMIUM SUITES

For even more luxurious space and amenities, Seabourn Venture has a limited number of **Owner's Suites**, **Signature Suites** and **Wintergarden Suites** offering extended dining areas, guest baths and wet bars, as well as additional amenities and special features — such as our extraordinary new two-story Wintergarden Suites, or the private canopied whirlpool spas on Signature Suites verandas. Our **Wintergarden Suites** can be connected to adjoining Veranda Suites to form Grand Suite configurations with multiple sleeping areas, bathrooms and verandas, perfect for families or groups traveling together.

For full descriptions and amenities by suite category visit Seabourn.com

RENDERING OF SIGNATURE SUITE LIVING ROOM



RIGHT PAGE: RENDERING OF WINTERGARDEN SUITE, LOWER FLOOR



4 THE UNPARALLELED SEABOURN EXPERIENCE YOU KNOW AND LOVE

SERVICE YOU CAN FEEL

Seabourn's smiling staff offers a relaxing, sincere and personalized style of service you can feel — a discernable difference between being merely catered to and being truly cared for. They never miss an opportunity to transform routine encounters into the sort of memorable occasions they call *Seabourn Moments*. Your personal suite stewardess perfectly embodies this spirit of hospitality, combining the skills of a butler with a cheerful, genie-like intuition to unobtrusively ensure that everything is always exactly as you wish.

UNRIVALED DINING EXPERIENCES AT SEA

Dining is an important facet of Seabourn's hospitality. Our skilled culinary team produces fresh, delicious and memorable cuisine equal to the finest restaurants anywhere, even as we sail in the most remote destinations.

Seabourn Venture offers guests an appealing array of tempting dining experiences including:

THE RESTAURANT Fine dining in an elegant, open-seating dining room for breakfast, lunch and dinner

THE COLONNADE A more casual alternative for buffet or table service breakfast and lunch, and themed dinner served tableside, including family-style menus by Michelin-starred Chef Thomas Keller

THE PATIO Casual, alfresco dining for lunch, weather permitting

SUSHI IN THE CLUB A variety of sushi bites are freshly made to order every evening

SEABOURN SQUARE A sociable oasis serving delectable specialty coffees, pastries, sandwiches and homemade gelati throughout the day and into the evening

PANTRY IN THE BOW LOUNGE Freshly prepared light fare to enjoy as you scan the horizon.

CONSTELLATION LOUNGE The spot for early-risers' pastries and beverages, elegant afternoon Tea Time and cocktail-time tapas

24-HOUR IN-SUITE DINING Choose from a varied menu anytime, or have dinner from The Restaurant menu served course-by-course in your suite or on your veranda

All dining options are complimentary, as are fine wines selected by our sommeliers. Cocktails, wines and other beverages are complimentary everywhere on board.

RENDERING OF CLUB LOUNGE



RENDERING OF SPA TREATMENT ROOM



RENDERING OF SPA SAUNA

SPA & WELLNESS WITH DR. ANDREW WEIL

Extend your expedition into your own physical, social, environmental and spiritual well-being with our first-ever program of its kind at sea. Based on Dr. Weil's groundbreaking research and bestselling books, the program incorporates a holistic mind and body approach including:

- A specially trained Mindful Living Coach
- Complimentary Yoga and Guided Meditation sessions
- Seminars in Integrative Medicine, Nutrition, Pain Management, Creative Aging and more

In addition, Seabourn Venture's well-appointed onboard spa facility offers:

- Skilled therapists for face and body massage, detox, cleansing and wrap services
- A well-equipped fitness center with a range of motion and variable resistance equipment
- A full-service hair styling, facial, manicure and pedicure salon for men and women
- A Fitness Director to assess, recommend and train various fitness regimes
- New to Seabourn and unique to Seabourn Venture – Sauna with floor-to-ceiling views for enhanced relaxation

SPA & WELLNESS
WITH DR. ANDREW WEIL



DR. ANDREW WEIL



THE SEABOURN ALL-INCLUSIVE EXPEDITION DIFFERENCE

Purpose-built expedition ships, PC6 ice-strengthened hull, with advanced maneuvering technology for superior stability, safety and comfort

World-class Expedition Team, delivering immersive experiences

All veranda, all ocean-front suites luxuriously appointed

Handcrafted itineraries developed for the expedition traveler to the most coveted and familiar remote destinations in the world

Intimate ships with a private club atmosphere

Intuitive, personalized service provided by staff passionate about exceeding guests expectations

Inclusive expedition experiences with **Zodiacs®**, **bikes**, **scuba diving** and **snorkeling**

Optional expedition experiences with **kayaks** and **custom-built, 6-guest submarines** giving the option to extend your expedition further for greater ocean exploration*

Welcome Champagne and **complimentary**

in-suite bar stocked with your preferences

Open bridge policy**, hosted by members of the Expedition Team providing firsthand access to the ship's command center and officers navigating your journey

World-class dining venues are all complimentary

Tipping is neither required, nor expected

Complimentary premium spirits and fine wines available on board at all times

Meticulous and purposeful adventurers' resort at sea designed for the luxury traveler with unique attributes and spaces to enhance your experience

Spa & Wellness with Dr. Andrew Weil, featuring an exclusive mindful living program*

Committed to **environmental stewardship and sustainability**

*Optional programs, for additional charge

**At the Captain's discretion

SUITE SCHEMATICS

SEABOURN VENTURE

Suites on board Seabourn Venture feature thoughtfully crafted bespoke furniture with enticing tactile materials and unique details, a comfortable living area, queen-size bed or two twin beds; walk-in closet with personal safe, personal heated wardrobe for expedition gear, interactive flat-screen TV with music and movies, fully stocked bar and refrigerator, writing desk with personalized stationery, makeup vanity, spacious bathroom with separate tub and shower, plush robes, slippers, hair dryer and 110/220V AC outlets.

GRAND WINTERGARDEN DECK 7

GR

Combine mid-ship Suites 733 and 735 for Suite 7353, or Suites 734 and 736 for Suite 7364 **Total space: 1,399 sq. ft. (130 sq.m.)** including two verandas totaling 205 sq. ft. (19 sq.m.).

New to Seabourn, Two level floor plan. **Lower:** Dining tables for two and four, guest bath, large windows, glass doors to two verandas, pantry with wet bar, two separate living areas, second bedroom and bathroom with separate tub and shower, walk-in closet and heated drying closet for expedition gear; writing desk; makeup vanity, stairway to: **Upper:** Separate master bedroom, master bath with whirlpool spa tub and separate shower, glass-enclosed solarium. An expensive wall of closets, a roll-up LG OLED TV and a tripod mounted Swarovski® ATX interior spotting scope.

AMENITIES INCLUDE:

All Veranda Suite Amenities plus:

- Complimentary internet service
- Enhanced in-suite bar setup
- Bottle of Shackleton Blended Malt Scotch Whiskey
- Welcome fresh flower bouquet
- Large customized fruit selection
- Nespresso® machine and coffees
- Soft, luxurious robe and slippers
- Daily newspaper or digital news
- Complimentary private car transfer up to 50 miles*

WINTERGARDEN SUITE DECK 7

WG

Suites 735, 736 **Total space: 1,044 sq. ft. (97 sq.m.)** including veranda of 129 sq. ft. (12 sq.m.).

New to Seabourn, Two level floor plan. **Lower:** seating and dining for four, guest bath, large windows, glass door to veranda, pantry with wet bar, walk-in closet and heated drying closet for expedition gear; writing desk; makeup vanity, stairway to **Upper:** Separate master bedroom, master bath with whirlpool tub and separate shower, glass-enclosed solarium. An expensive wall of closets, a roll-up LG OLED TV and a tripod mounted Swarovski® ATX interior spotting scope.

AMENITIES INCLUDE:

All Veranda Suite Amenities plus:

- Complimentary internet service
- Enhanced in-suite bar setup
- Bottle of Shackleton Blended Malt Scotch Whiskey
- Welcome fresh flower bouquet
- Large customized fruit selection
- Nespresso® machine and coffees
- Soft, luxurious robe and slippers
- Daily newspaper or digital news
- Complimentary private car transfer up to 50 miles*

SIGNATURE SUITE DECK 8

SS

Suites 832, 833 **Total space 1,377 sq. ft. (128 sq.m.)** including veranda of 592 sq. ft. (55 sq.m.).

Foyer entry to living area, dining table for four, guest bath, pantry with wet bar, large windows, glass door to large curved veranda with canopied whirlpool spa & sofa, separate bedroom with window, walk-in closet and heated drying closet for expedition gear; writing desk; makeup vanity.

AMENITIES INCLUDE:

All Veranda Suite Amenities plus:

- Complimentary internet service
- Enhanced in-suite bar setup
- Bottle of Shackleton Blended Malt Scotch Whiskey
- Welcome fresh flower bouquet
- Large customized fruit selection
- Nespresso® machine and coffees
- Soft, luxurious robe and slippers
- Daily newspaper or digital news
- Complimentary private car transfer up to 50 miles*

OWNER SUITE DECK 7

OW

Suites 700, 701 **Total space: 1,023 sq. ft. (95 sq.m.)** including veranda of 484 sq. ft. (45 sq.m.).

Living area, dining table for two to four, separate bedroom, large forward-facing windows, glass door to curved veranda with table for four, walk-in closet and heated drying closet for expedition gear; writing desk; makeup vanity.

AMENITIES INCLUDE:

All Veranda Suite Amenities plus:

- Complimentary internet service
- Enhanced in-suite bar setup
- Bottle of Shackleton Blended Malt Scotch Whiskey
- Welcome fresh flower bouquet
- Large customized fruit selection
- Nespresso® machine and coffees
- Soft, luxurious robe and slippers
- Daily newspaper or digital news
- Complimentary private car transfer up to 50 miles*

PENTHOUSE SPA SUITE DECK 7

PS

Suite 739 **Total space: 527 sq. ft. (59 sq.m.)** including veranda of 97 sq. ft. (19 sq.m.).

Living area with dining table for two, large windows, sliding glass door to veranda, separate bedroom, walk-in closet and heated drying closet for expedition gear; writing desk; makeup vanity.

AMENITIES INCLUDE:

All Veranda Suite Amenities plus:

- Private sleeping area with a second high-definition TV
- Fresh floral arrangement
- Full-sized Molton Brown amenities
- Additional Pure Pampering™ bath amenities
- Nespresso® machine and coffees
- Spa Welcome Basket
- Oversize Spa shower with rainfall shower head
- Molton Brown Spa selection
- Bathroom Scale
- Health bar with juices, waters
- Tea kettle and tea selection
- Spa snack mix
- Daily smoothie with in-suite breakfast
- Spa Concierge Services
- Soothing music and essential oil diffusion

PENTHOUSE SUITE DECK 8

PH

Suites 818-821, **Total space: 527 sq. ft. (49 sq.m.)** including veranda of 97 sq. ft. (9 sq.m.).

Suites 826-827, **Total space: 624 sq. ft. (58 sq.m.)** including veranda of 205 sq. ft. (19 sq.m.).

ADA Compliant:

Suite 800 **Total Space: 527 sq. ft. (49 sq.m.)** including veranda of 97 sq. ft. (9 sq.m.).

Living area with dining table for two, large windows, sliding glass door to veranda, separate bedroom with queen-size or two twin beds, bathroom with shower & tub, walk-in closet and heated drying closet for expedition gear; writing desk; makeup vanity.

AMENITIES INCLUDE:

All Veranda Suite Amenities plus:

- Private sleeping area with a second high-definition TV
- Fresh floral arrangement
- Full-sized Molton Brown amenities
- Additional Pure Pampering™ bath amenities
- Nespresso® machine and coffees

PANORAMA VERANDA SUITE DECKS 5, 6, 7 & 8

VP

Suites 513-516, 611-614, 711-714, 803-805 **Total space: 420 sq. ft. (39 sq.m.)** including veranda of 86 sq. ft. (8 sq.m.).

New to Seabourn floor plan Sub-floor radiant heating throughout, seating area with and curved panoramic windows, sleeping area with queen sized or two twin beds, dining table for two, glass door to veranda, walk-in closet and heated drying closet for expedition gear; writing desk; makeup vanity. The bathroom features a separate shower and large soaking tub next to a window providing relaxing scenic views.

AMENITIES INCLUDE:

All Veranda Suite Amenities plus:

- A Personal Suite Stewardess to ensure everything in your suite is always as you wish
- Luxurious custom-built mattress, fine cotton linens, all-season duvet and your choice of firm or soft pillows
- Ample storage and walk-in closets with plush terry robes, slippers and a personal safe
- In-suite bar with a selection of beverages and your requested complimentary wines or spirits
- Interactive entertainment with broadcast TV and hundreds of movie and music choices
- Bath with a full tub, separate shower and luxury products featuring an exclusive signature scent created for Seabourn by Molton Brown, London
- Complimentary PressReader™ app brings your favorite newspapers and magazines to your phone or tablet
- Unique to Seabourn Venture, Swarovski® binoculars for use during the voyage

VERANDA SPA SUITE DECK 7

VS

Suites 741, 743 **Total Space: 355 sq. ft. (33 sq.m.)** including veranda of 75 sq. ft. (7 sq.m.).

Seating area with coffee/dining table for two, sliding glass door to veranda, queen-size or two twin beds, bathroom with spa shower and tub, walk-in closet and heated drying closet for expedition gear; writing desk; makeup vanity.

AMENITIES INCLUDE:

All Veranda Suite Amenities plus:

- Spa Welcome Basket
- Oversize Spa shower with rainfall shower head
- Molton Brown Spa selection
- Bathroom Scale
- Health bar with juices, waters
- Tea kettle and tea selection
- Spa snack mix
- Daily smoothie with in-suite breakfast
- Spa Concierge Services
- Soothing music and essential oil diffusion

VERANDA SUITE DECKS 5, 6, 7 & 8

V1 V2 V3 V4

Total space: 355 sq. ft. (33 sq. m.) including veranda of 78 sq. ft. (7 sq. m.) Suites 824, 825 **Total space: 678 sq. ft. (63 sq.m.)** including veranda of 247 sq. ft. (23 sq.m.). As above with wheelchair accessible bathroom.*

Suite 738 **Total space: 560 sq. ft. (52 sq.m.)** including veranda of 129 sq. ft. (12 sq.m.). As above with wheelchair accessible bathroom.

Suite 737 **Total space: 689 sq. ft. (64 sq.m.)** including veranda of 258 sq. ft. (24 sq.m.). As above with wheelchair accessible bathroom. Seating area with coffee/dining table for two, queen-size or two twin beds, sliding glass door to veranda, bathroom with separate shower and tub, walk-in closet and heated drying closet for expedition gear; writing desk; makeup vanity.

AMENITIES INCLUDE:

- A Personal Suite Stewardess to ensure everything in your suite is always as you wish
- Luxurious custom-built mattress, fine cotton linens, all-season duvet and your choice of firm or soft pillows
- Ample storage and walk-in closets with plush terry robes, slippers and a personal safe
- In-suite bar with a selection of beverages and your requested complimentary wines or spirits
- Interactive entertainment with broadcast TV and hundreds of movie and music choices
- Bath with a full tub, separate shower and luxury products featuring an exclusive signature scent created for Seabourn by Molton Brown, London
- Complimentary PressReader™ app brings your favorite newspapers and magazines to your phone or tablet
- Unique to Seabourn Venture, Swarovski® binoculars for use during the voyage

*Not applicable to upgraded occupancy

**On select voyages

Diagrams are for illustration only. Actual suite configuration may vary. Sq.ft. and sq.m. amounts are approximations, and may vary.

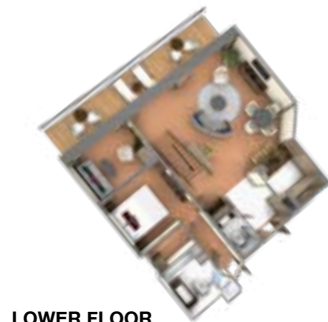

LOWER FLOOR



UPPER FLOOR



LOWER FLOOR



UPPER FLOOR

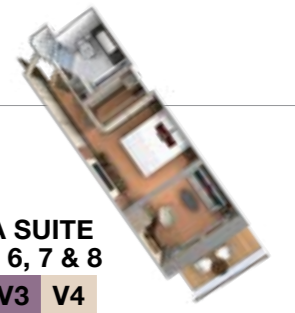

DECK PLANS



SEABOURN VENTURE

SHIP SPECIFICATIONS & FACILITIES

- 8 Dining Experiences
- 24-hour in-suite room service
- Seabourn Square with coffee, bar, library, business center & concierge
- 8 Lounges & Bars
- Spa & Salon
- Fully equipped fitness center
- 4 Outdoor whirlpools
- 1 Outdoor Infinity pool

Connecting Suites

When combining the following suites, their suite numbers change as follows:

Suites 733 and 735 become Grand Wintergarden Suite 7353;

suites 734 and 736 become Grand Wintergarden Suite 7364;

Wheelchair Accessible Suites

Suites 737, 738, 800, 824 and 825 include ADA shower only and wheelchair-accessible doorways.

Elevator

- Self Service launderette

SUITE CATEGORIES



BUILT:

Seabourn Venture – December 2021
 Ships' registry: Bahamas
 Hull: PC6
 Cruising speed: 19 Knots
 Gross tonnage: 23,000
 Guest capacity: 264
 Length: 565 feet
 Beam: 79 feet
 Nationality of Officers, Staff & Crew: International
 Stabilizers: Yes
 Propulsion: 2 Azipods®
 Electric current: 110/220 AC

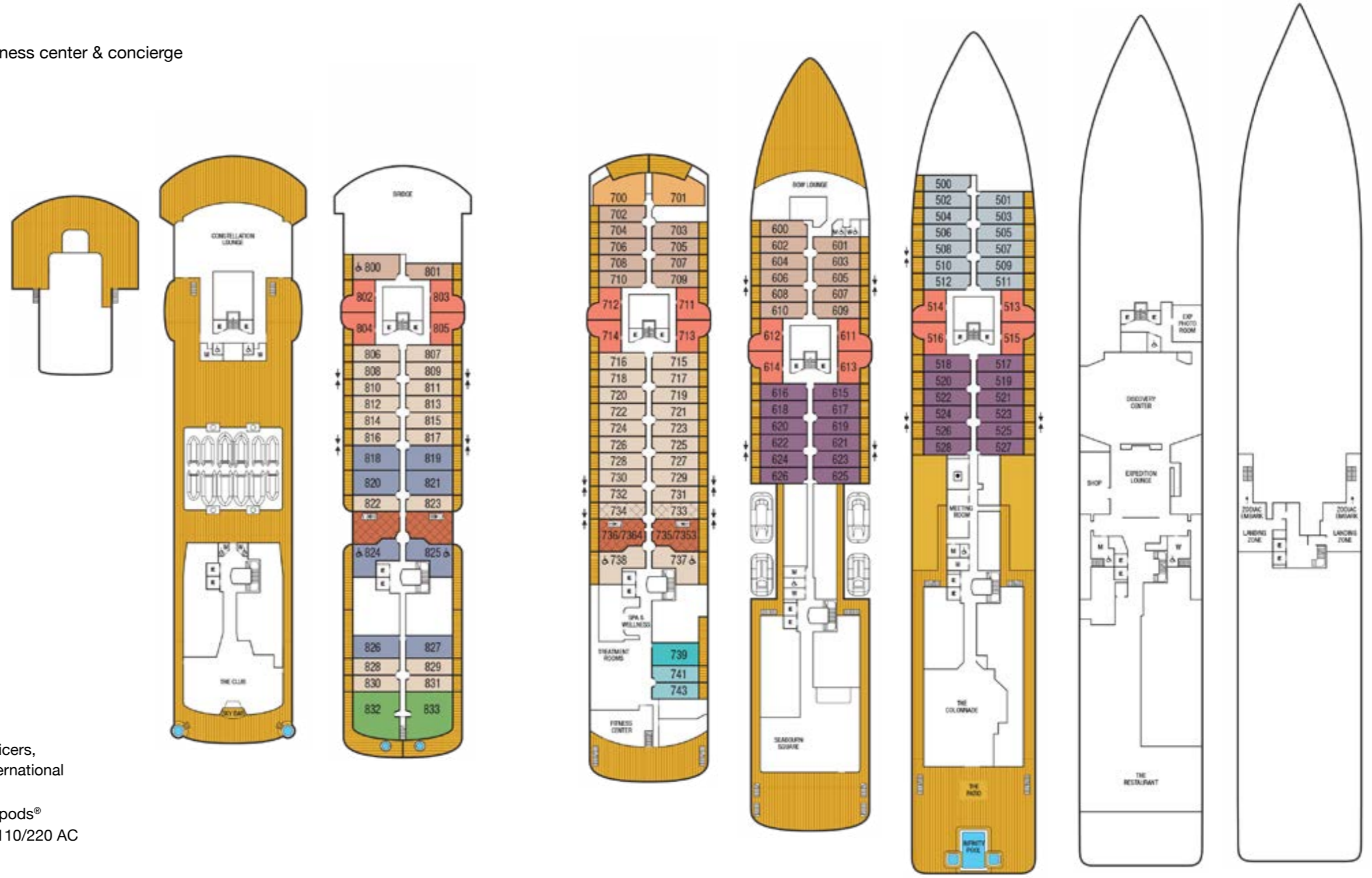

DECK 10 | DECK 9 | DECK 8 | DECK 7 | DECK 6 | DECK 5 | DECK 4 | DECK 3

Deck plan shown is for illustration purposes. Seabourn reserves the right to make amendments and changes. Effective November 2020.



SEABOURN®

Visit us at **Seabourn.com** to plan your voyage,
or sign-up for special offers and news.

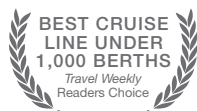
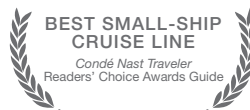
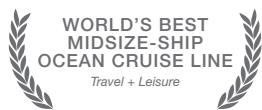

SEABOURN IS A PROUD MEMBER OF



Travel+Leisure and Time Inc. Affluent Media Group are not affiliated with, and do not endorse products or services of, Seabourn. *Travel+Leisure* is a registered trademark of Time Inc. Affluent Media Group and is used under license.
